

## Electr-O-Fuze™ Spigot Transition Fitting, UL971 Listed

### Product Description

Electr-O-Fuze™ Transition Fittings are safe, reliable and a proven method of connecting Electr-O-Fuze™ pipe to steel threaded parts. The transition fitting come in various different styles and sizes to suite the application. Two main styles are stock items namely the threaded transitions and the E-Z Fit. Both these are electro plated with a 12 inch hose tail as standard; however the metal transition section can be made of Stainless Steel to order. Also made to order are transitions with longer hose tails, these can be made up to any length. A further advantage is that these fittings are completely fluorinated for maximum protection against hydrocarbons. Electr-O-Fuze™ Transition Fittings are also threaded both on the outside and inside for ease of application offering different options during installation. When used in conjunction with Electr-O-Fuze™ pipe and an Electr-O-Fuze™ EF welding machine, it provides a UL971 compliant fuel installation with a 30 year life span.



Electr-O-Fuze™ Transition Fitting is available in sizes 1¼”, 1½”, 2”, 3” and 4” nominal bore.

### Applications

- |                        |   |
|------------------------|---|
| ○ Service Stations     | ○ Refineries                            |
| ○ Marinas              | ○ Harbors                               |
| ○ Fuel Terminals       | ○ Airports                              |
| ○ Moist & Marshy Areas | ○ Non-Contaminated & Contaminated Sites |

### Specifications

- |                          |  |
|--------------------------|--|
| ○ Fitting Type:          | Spigot ends to the transition allow easy matching to various electrofusion fittings such as couplers, tee’s and elbows among others throughout the pipeline system in order to join the various pieces. The long spigot allows length adjustment to the fitting for precise fitting, applied with dedicated ancillary equipment ensures maximum joint integrity. Absolute security of the weld is ensured using the system listed electrofusion fittings with the bar code feature in conjunction with the fully automatic Electr-O-Fuze™ welding machine. The transition Spigot is threaded both on the inside and outside with NPT thread for flexibility of use and is factory leak tested. |
| ○ Electrofusion Machine: | None, Spigot Type.   |
| ○ Temperature Range:     | Fittings can be worked with at ambient temperatures between –24°F and 160°F.   |
| ○ Pipe Fusion Range:     | The fittings can be fused to pipe of SDR stages 17.6 to 7.4 in accordance with DIN 8074 (E), ISO 4437, pr EN 1555 and DIN EN 12201 (E).  |
| ○ Operating Pressures:   | 150 psi maximum.   |
| ○ Test Pressure:         | Primary>60psi<150psi   |
| ○ Approved Fuel Types:   | All Petroleum Products ( <i>Motor Vehicle Fuels, High Blend Fuels, Concentrated Fuels, Aviation &amp; Marine Fuels</i> ) E85 and Biodiesel.  |

### Installation

Installation, use, and maintenance of all Electr-O-Fuze™ products shall be in accordance with the manufacturer’s recommendations, State and County approvals. In event of conflicts, the stricter requirement shall govern. AEP installation manual available directly from AEP, or at info@aep-inc.net. All operators to be AEP certified on both the fittings and electrofusion machine.

### Certifications/Approvals

- |                                |   |
|--------------------------------|---|
| ○ UL 971 Approved              | File # MH47372  |
| ○ Institute of Petroleum       | Cert # BC63/1010/98/001 And cert # BC63/0115/2000/001 |
| ○ Shell Int. Procurement Cert. | Cert # BC63/1010/98/002                               |
| ○ State of Florida             | EQ 683 and EQ 617 – and Derm Approval                 |
| ○ State of Michigan            | MUSTR – Rule 9, subsections 280.20 (b)                |
| ○ New York City Fire Dept.     | CoA 5117  |
| ○ DOT 192 and 195              | On waiver letter per project                          |
| ○ State of California          | CARB, State Fire Marshall Cert # GVRC 005:060:001     |

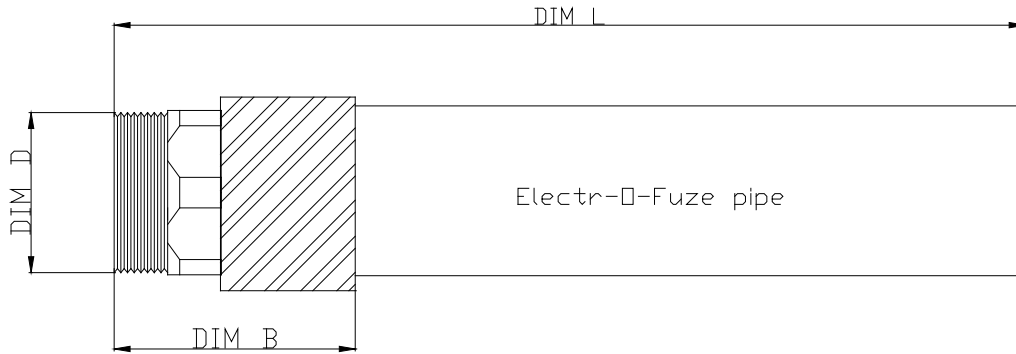

Diam. NB* inches	Diam. OD** metric	Part #	Dim B		Dim D		Dim L		Weight kg/ea	Weight lbs/ea
			mm	in.	mm	in.	mm	in.		
1¼"	40	TR-SP-1.25M	82	3.23"	32	1¼"	282	11.10"	0.9	1.98
1½"	50	TR-SP-1.5M	86	3.39"	47	1½"	286	11.26"	1.0	2.20
2"	63	TR-SP-2M	92	3.62"	60	2"	292	11.50"	2.0	4.40
3"	90	TR-SP-3M	124	4.88"	87	3"	324	12.76"	2.8	6.16
4"	110	TR-SP-4M	134	5.28"	102	4"	334	13.15"	3.0	6.60

Diam. NB* inches	Diam. OD** metric	Part #	Dim B		Dim D		Dim L		Weight kg/ea	Weight lbs/ea
			mm	in.	mm	in.	mm	in.		
1¼"	40	TR-SP-1.25M	82	3.23"	<b>25.0</b>	<b>1"</b>	282	11.10"	0.9	1.98
1½"	50	TR-SP-1.5M	86	3.39"	<b>31.8</b>	<b>1¼"</b>	286	11.26"	1.0	2.20
2"	63	TR-SP-2M	92	3.62"	<b>38.1</b>	<b>1½"</b>	292	11.50"	2.0	4.40
3"	90	TR-SP-3M	124	4.88"	<b>63.5</b>	<b>2½"</b>	324	12.76"	2.8	6.16
4"	110	TR-SP-4M	134	5.28"	<b>76.2</b>	<b>3"</b>	334	13.15"	3.0	6.60

(\*) Nominal Bore

(\*\*) Outside Diameter